

TREE TABLE							
Tree No.	Easting	Northing	Trunk Dia.(m)	Canopy Dia.(m)	Type	Height	No.Trunks
145	207365.755	599261.989	0.60	12.0	EUCALYPT	14.8	3
147	207367.213	599259.361	0.22	3.5	EUCALYPT	7.7	1
150	207370.598	599259.952	0.58	13.0	EUCALYPT	15.6	1
152	207379.441	599261.075	0.35	7.5	EUCALYPT	10.7	1
154	207386.924	599254.813	0.18	4.5	EUCALYPT	8.2	1
156	207388.354	599245.890	0.39	5.5	EUCALYPT	6.0	2
158	207397.502	599247.480	0.34	7.5	EUCALYPT	13.4	1
160	207398.391	599243.791	0.50	8.0	EUCALYPT	8.4	2
162	207399.107	599240.031	0.34	8.5	EUCALYPT	11.8	1
164	207398.555	599235.835	0.67	9.0	EUCALYPT	10.1	2
166	207398.553	599232.290	0.36	9.5	EUCALYPT	14.5	1
168	207402.815	599233.599	0.32	5.0	EUCALYPT	13.2	1
172	207401.433	599229.386	0.37	7.0	EUCALYPT	11.5	1
174	207404.599	599226.501	0.32	5.0	EUCALYPT	13.2	1
176	207408.287	599226.599	0.40	9.5	EUCALYPT	12.6	1
178	207405.077	599229.559	0.24	5.0	EUCALYPT	10.2	1
180	207409.594	599230.081	0.35	5.5	EUCALYPT	14.5	1
182	207409.234	599233.926	0.30	6.0	EUCALYPT	13.0	1
184	207419.102	599229.720	0.17	2.5	EUCALYPT	5.1	1
186	207414.157	599241.227	0.38	8.5	EUCALYPT	13.4	1
188	207405.841	599233.459	0.23	4.0	EUCALYPT	10.7	1
238	207391.975	599179.501	0.55	7.5	EUCALYPT	12.0	1
239	207390.625	599176.269	0.31	6.0	EUCALYPT	7.7	1
240	207385.356	599164.515	0.68	7.5	EUCALYPT	9.4	3
241	207383.329	599162.104	0.45	5.0	EUCALYPT	8.6	1
242	207377.192	599161.326	0.28	5.0	EUCALYPT	9.4	1
243	207374.162	599167.040	0.36	4.0	EUCALYPT	9.0	2
244	207370.743	599168.769	0.35	2.0	EUCALYPT	7.7	3
245	207363.456	599173.421	0.40	4.0	EUCALYPT	9.7	2
246	207360.927	599174.673	0.30	3.5	EUCALYPT	7.3	3
247	207355.824	599177.216	0.39	6.5	EUCALYPT	9.6	1
248	207411.241	599220.062	0.32	8.5	EUCALYPT	11.8	1
249	207360.029	599171.505	0.30	4.5	EUCALYPT	8.1	1
251	207339.476	599190.487	0.24	4.0	EUCALYPT	14.1	1
252	207336.398	599194.048	0.65	7.5	EUCALYPT	14.9	1
253	207334.523	599197.635	0.28	6.0	EUCALYPT	11.8	1
254	207338.337	599200.218	0.37	3.0	EUCALYPT	8.4	2
255	207341.420	599195.592	0.33	4.0	EUCALYPT	13.1	1
256	207344.208	599193.709	0.70	8.0	EUCALYPT	15.5	2
257	207345.419	599196.920	0.28	3.5	EUCALYPT	6.6	2
258	207342.584	599199.353	0.40	4.0	EUCALYPT	9.3	2
259	207412.470	599214.621	0.52	5.5	EUCALYPT	9.9	2
260	207340.598	599205.641	0.18	2.5	EUCALYPT	8.0	1
261	207344.148	599202.594	0.49	3.5	EUCALYPT	7.0	4
262	207346.371	599210.047	0.62	8.5	EUCALYPT	10.8	1
263	207349.226	599208.060	0.23	4.5	EUCALYPT	7.5	1
264	207350.440	599211.666	0.30	5.5	EUCALYPT	8.9	2
265	207351.924	599215.304	0.86	10.0	EUCALYPT	10.0	3
266	207349.801	599220.376	0.42	3.5	EUCALYPT	8.3	2
267	207355.028	599225.696	0.72	9.0	EUCALYPT	10.7	3
268	207348.974	599231.197	0.65	13.0	EUCALYPT	12.4	1
269	207353.320	599230.814	0.15	2.5	EUCALYPT	6.2	1
270	207409.767	599208.652	0.45	4.0	EUCALYPT	5.7	3
271	207358.647	599235.793	0.40	8.5	EUCALYPT	12.3	1
272	207355.291	599237.591	0.22	3.5	EUCALYPT	7.0	1
273	207356.879	599241.404	0.34	7.0	EUCALYPT	11.1	1
274	207359.967	599239.371	0.31	4.5	EUCALYPT	11.2	1
275	207360.486	599252.144	0.28	5.0	EUCALYPT	10.2	1
276	207371.542	599156.462	0.27	7.0	DECIDUOUS	6.3	1
277	207382.388	599154.380	0.38	8.0	EUCALYPT	9.4	1
278	207379.212	599156.606	0.33	6.5	EUCALYPT	10.7	1
279	207376.626	599158.116	0.23	3.5	DECIDUOUS	8.9	1
280	207371.068	599164.801	0.39	3.5	EUCALYPT	10.4	2
281	207403.900	599204.657	0.47	6.5	EUCALYPT	11.0	2
282	207365.018	599165.607	0.58	8.0	EUCALYPT	9.7	2
283	207361.869	599166.956	0.18	2.0	DECIDUOUS	7.9	1
284	207359.513	599168.511	0.20	2.5	EUCALYPT	7.6	1
285	207356.568	599169.034	0.45	3.5	DECIDUOUS	6.2	3
286	207355.206	599166.837	0.23	5.5	DECIDUOUS	6.4	1
287	207349.299	599167.657	0.19	4.0	DECIDUOUS	6.4	1
288	207352.246	599171.948	0.36	4.0	DECIDUOUS	7.5	2
289	207337.242	599174.865	0.25	5.5	DECIDUOUS	5.9	1
290	207335.141	599180.195	1.00	8.0	EUCALYPT	8.4	4
291	207336.217	599182.656	0.20	3.0	EUCALYPT	10.2	1
292	207402.437	599202.019	0.23	3.5	EUCALYPT	9.5	1
293	207339.352	599181.652	0.36	5.5	EUCALYPT	9.2	2
294	207338.341	599185.839	0.20	3.0	EUCALYPT	6.6	1
303	207403.497	599196.263	0.30	5.5	EUCALYPT	9.2	1
314	207402.079	599193.672	0.45	5.0	EUCALYPT	8.2	3
316	207394.743	599186.405	0.23	4.0	EUCALYPT	9.7	1
317	207393.208	599183.146	0.39	9.0	EUCALYPT	11.4	1

LEGEND

- GRANICE PARCELE

GRANICE GRAĐENJA

ZONA VISOKOG ZELENILA
U KOJOJ JE SVA STABLA OBAVEZNO SAČUVATI
- COMMUNICATION-PIT

ELECTRICITY-STREET LIGHT

SEWERAGE-MANHOLE

STORM WATER-MANHOLE

VEGETATION-TREE

WATER SERVICE-HYDRANT

BOUNDARY-BLOCK (ADJOINING)

BOUNDARY-BLOCK (SUBJECT)

COMMUNICATION-LINE U/G

ELECTRICITY-LINE U/G (B)

GAS-PIPE U/G (B)

MINOR STRUCTURE-FENCE

ROAD-KERB BACK

ROAD-KERB INVERT

ROAD-KERB LIP

ROAD-KERB TOP

SEWERAGE- U/G

STORM WATER-PIPE U/G

STORM WATER-WATER COURSE

NAPOMENA

- U GRAFIČKOM PRIKAZU POZICIJA STABLA JE INDIKATIVNA I RELATIVNO TAČNA, DOK SU DIMENZIJA I OBLIK SIMBOLIČNI.
- PRECIZNI PODACI O POZICIJI (KOORDINATE) I DIMENZIJAMA SVAKOG STABLA, VEZANO ZA POZICIJU OBELEŽENU BROJEM U GRAFIČKOM PRIKAZU DATI SU U TABELI

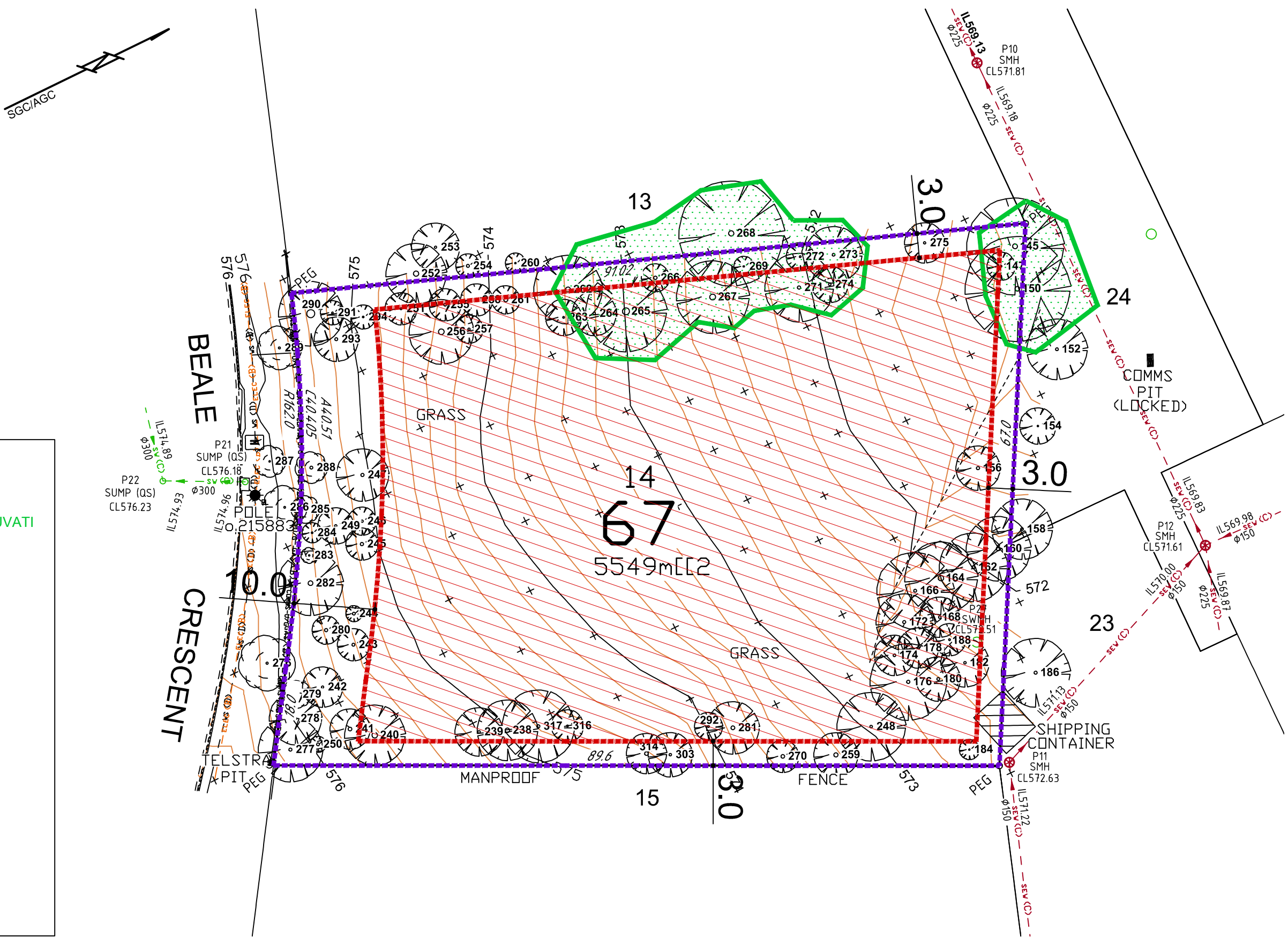

OGRANIČENJA ZA KONKURSN0 PODRUČJE